

# GE BAI

## Interior Designer

WELL AP, LEED GREEN ASSOCIATE

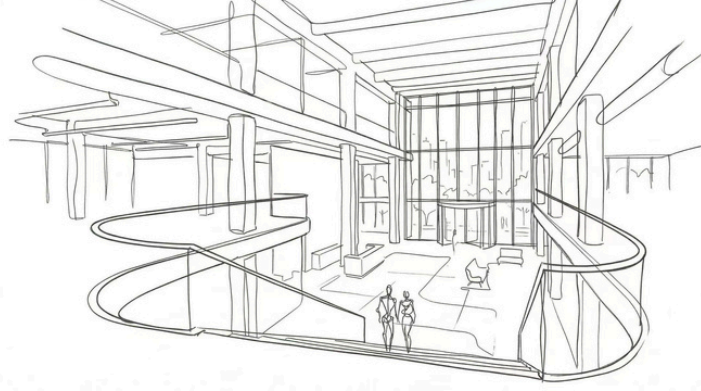

### ABOUT ME

Strategic and creative Interior Designer with 5+ years of experience delivering high-impact spatial solutions. I possess extensive expertise across all phases of interior design, from concept to completion. Dedicated to creating cohesive environments that harmonize people, space, and nature while celebrating local culture through comprehensive, sustainable design.

### CONTACT

- +1 (404) 719-0885
- Atlanta, GA 30339
- [www.gbaidesign.com](http://www.gbaidesign.com)
- [g.bai.dsgn@gmail.com](mailto:g.bai.dsgn@gmail.com)

### EDUCATION

#### SAVANNAH COLLEGE OF ART AND DESIGN

Master of Fine Arts, Interior Design  
2019 - 2022  
GPA: 4.0

#### YUNNAN UNIVERSITY OF FINANCE AND ECONOMICS

Bachelor of Arts, Environmental Design  
2014 - 2018

### SKILLS

- Design Software: Revit (BIM), AutoCAD, ArchiCAD, SketchUp, 3ds Max.
- Visualization: Enscape, Lumion, V-Ray, Adobe Creative Suite (PS, AI, ID).
- Technical: Bluebeam Revu, Construction Docs, FF&E Spec, Code Compliance.
- Languages: English & Chinese (Mandarin).

### WORK EXPERIENCE

#### PEACOCK PARTNERSHIP

Interior Designer of Healthcare | 2025-Present

- Delivered all design phases for 20,000+ sq. ft. healthcare projects, specializing in the spatial layout and technical development of high-complexity dental clinics.
- Facilitated comprehensive CD sets while coordinating MEP requirements and submittal reviews to ensure seamless project completion.
- Mentored junior designers on technical standards and design workflows to enhance team productivity.

#### B+G ART DESIGN WORKS

Creative Director | 2025

- Managed end-to-end interior design for retail and hospitality projects, directing all phases from concept to CD.
- Led vendor coordination, managing shop drawings and purchasing to ensure cost-effective project delivery.

#### BHDP ARCHITECTURE

Interior Designer of Retail and Workplace | 2022-2025

- Conducted field surveys and CD set production for 50,000+ sq. ft. retail and workplace projects, ensuring strict compliance with IBC and ADA codes.
- Streamlined space planning and FF&E lifecycle, coordinating with MEP consultants and vendors on shop drawing approvals to ensure technical integration.
- Developed high-fidelity 3D visualizations and strategic presentation decks to secure client approval and communicate design intent.

#### SOOCHOW GOLD MANTIS LANDSCAPE CO., LTD.

Interior Design Intern of Hospitality | 2019

- Produced CD sets and technical detailing for a museum project, integrating local cultural motifs and sustainable FF&E specifications through rigorous material research.

Work Authorization: U.S. Permanent Resident; no visa sponsorship required.